

Installation guide for ecoBETA® USAV dual-flush valve



STEP 1

Turn off water supply to tank.
Empty tank.



STEP 2

Disconnect water supply connection
hose.



STEP 3

Remove water tank screws.
Remove water tank.



USAV parts



STEP 4

Remove existing flush valve.
Insert flush valve into tank with
gasket inside tank. **Do not use
putty.**



STEP 5

Use wrench to tighten the nut. **Do no
overtighten.**
Keep clear of the tank screws inside
tank cf. step 7



STEP 6

Keep clear of the tank screws inside tank. Set up bowl refill
hose between refill valve and flush valve clip.
Connect valve string to tank lever. Check mechanical function.



STEP 7

Fit bowl / tank gasket.
Mount tank in correct
position on bowl.

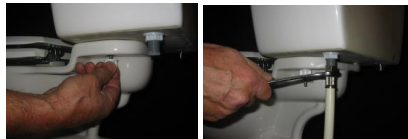

STEP 8

Tighten tank screws. Connect
water supply hose. **Do not
overtighten.**



STEP 9

Position cup to adjust small
flush. Turn cup - position -
turn back:
Upwards for less water
Downwards for more water

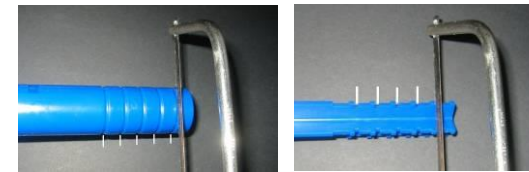

SHORTEN THE VALVE IF NECESSARY:

To fit the valve into a low tank model,
always cut off the same number of
segments from valve shaft and guide rod.



STEP 10

Stick label
next to lever.

Function:

Small flush: Press and let go

Large flush: Press and hold until tank is empty

Troubleshooting:

Toilet is leaking into bowl: Water level too high. Adjust.
String too short. Extend.
Movable part of valve cannot move freely.

Small flush is too small: Move floater cup downwards (step 9).
Adjust water level downwards.

Small flush is too big: Move floater cup upwards (step 9).
Adjust water level downwards.

Bowl is not refilling: Hose between refill valve and flush valve is defective or not connected.

| | |
|-------------------|---|
| GUARANTEE: | This ecoBETA® product is guaranteed to be free from defective materials and workmanship for a period of 1 year. Units returned to ecoBETA® Denmark will be replaced free of charge. |
|-------------------|---|

| | |
|-----------------|--|
| WARNING: | Manufacturer shall not be responsible or liable for any failure or damage of this product by the use of Chlorine or Chloramines in the treatment of public water supplies or by other plumbing products containing Calcium Hypochlorite (Chlorine) and/or Ammonia. Do not overtighten nuts or tank/bowl may crack. |
|-----------------|--|